

HARDWARE INSTALLATION

Our engage hub is simple to install and use. A CT sensor is clipped onto the live feed cable of your breaker panel. A lead from the sensor is connected to the efergy transmitter. This transmitter wirelessly sends real-time data to the hub. The engage hub is connected to your internet router via an ethernet cable. The web platform or app will then show you how much energy you are using in the same units that are on your bill.

1. Find the Main Feed Wires

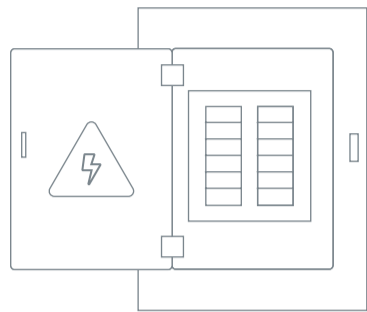
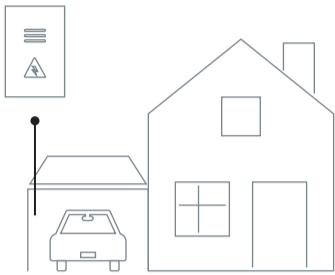

You can normally find your main electrical panel inside your home on the other side of the wall from your electric utility meter.

Remove the outside cover from your electrical panel and locate the main feed wires. You should find up to four feed wires entering your main electrical panel.

1

Common electrical panels

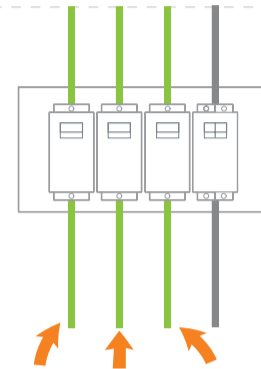
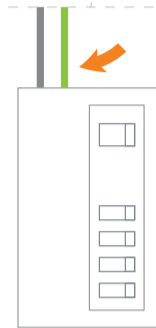
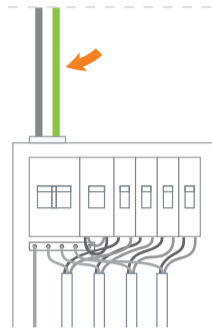
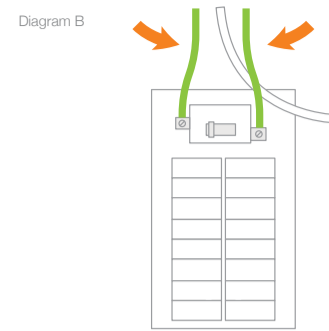
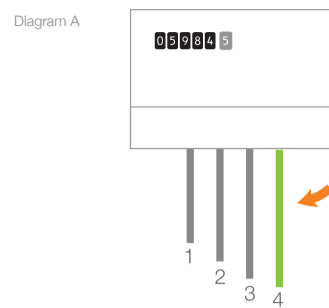

Diagram C

Diagram D

Diagram E

2

2. Install the sensor(s) and transmitter

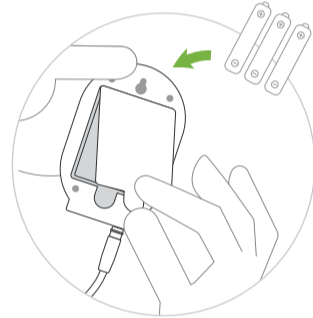

Place the sensors around the feed wires of your electric panel. Pull the clasp to open the sensor, place it around the feed cable and push the clasp to shut.

Insert the sensors jack into the base of the transmitter. Make sure you insert the sensor(s) jack first, then power on the Transmitter.

Open the Transmitter case and insert three AA batteries (not provided). Mount the transmitter on the wall next to or above the electric panel.

ⓘ Efergy recommends high quality alkaline or lithium batteries for the best product performance. Battery life will depend on environment (up to 12 months).

⚠ EFERGY RECOMMENDS THAT INSTALLATION IS CARRIED OUT BY A QUALIFIED ELECTRICIAN

3

2. Connect and Power up Engage Hub



Place the hub next to or nearby the router. We recommend you to complete the installation near the computer.

Plug the engage hub into a mains power source using the supplied AC adaptor, and into a spare port on a router with internet access using the LAN cable provided.

The red light will light continuously, showing that the hub is powered on. The green light should come on for a few seconds and then go out. The yellow light will flash, indicating that the hub is looking for a transmitter within range. Within a minute or two you should see the yellow light come on and stay on solid for a few seconds and then go out.

4

SET UP THE HUB

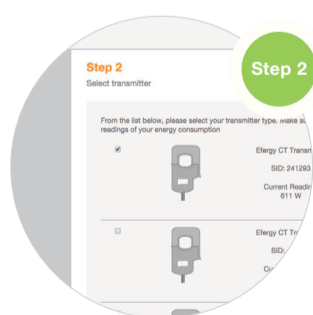
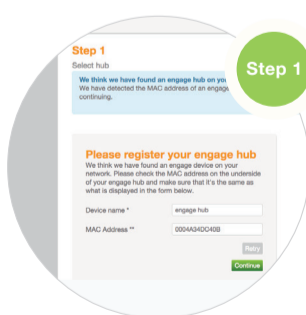

Visit engage.efergy.com, create your account with or open your existing account. New accounts, simply follow prompts to fully register.

The platform will automatically detect the MAC address of your hub. Make sure that it's the same as what is displayed in the form, input a device name and press Continue.

Select your transmitter type. Make sure that you select the correct Sensor/Transmitter to get accurate readings of your energy consumption. Input a name for the sensor, select an option from the dropdown list and enter the voltage and press **Continue**.

Note: If the platform can't find your new hub, the router may need to be reset

5

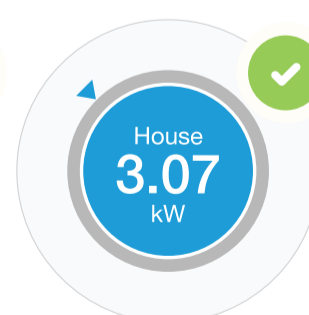
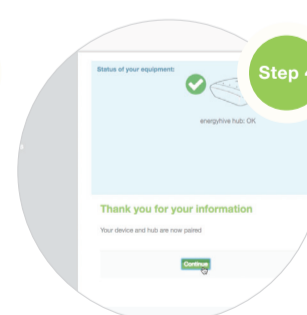
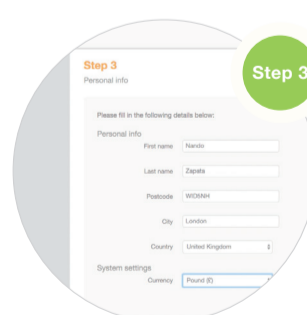

Fill in your personal info (First name, Last name, Postcode, City and Country) and system settings (Currency). Press Continue to pair your engage with the platform.

The platform will associate the devices and complete the pairing process. Your device is now paired.

The hub is now connected to your Wi-Fi network and registered on the Engage system. You should so view your energy consumption in real-time.

6



Set up your site settings

Click the **Settings** button located on the top right of the platform and update the currency, tariff price, budget, kgCO₂ and voltage information.

Now you can monitor and manage your energy on desktop.



7

MEET THE ENGAGE PLATFORM

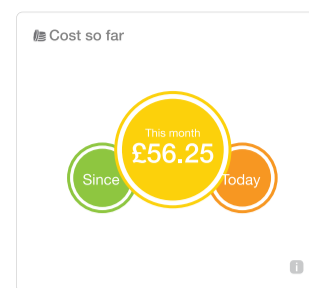
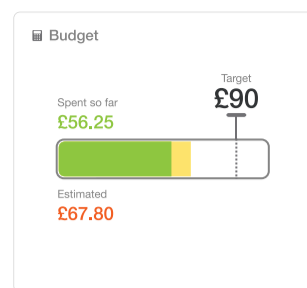
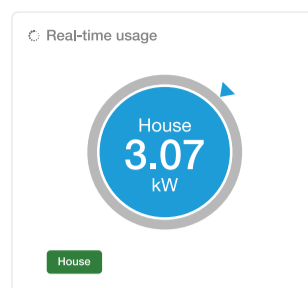

Energy now

Instant energy information is key to successful home energy management, after all you can't save what you can't see!

Budget

This feature lets you set your own monthly target and will show you exactly where you are in relation to that.

Cost so far

See how much you have spent so far. You can choose to see what you have spent so far today, this month or from a date of your choice.

8

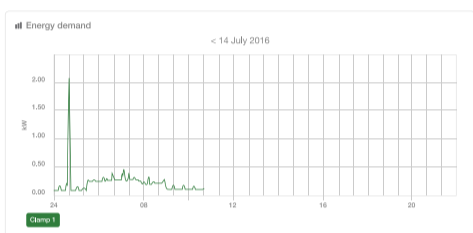

Energy demand

Gain a broader understanding of your power demand. See when and how you consumed electricity and exactly how much power it demanded from the grid.

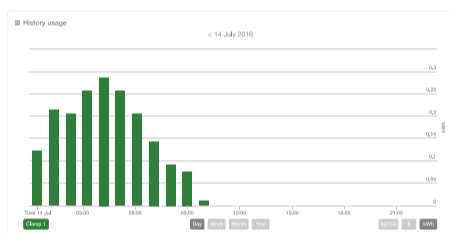

Usage history

Check the amount of energy consumed per day, week, month or year. Monitor up to 5 circuits, perfect for solar installations (with STXtra sensors and transmitters).

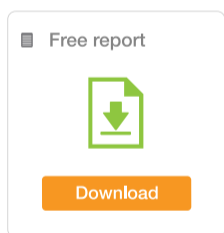

Download report

Download your recorded data to your PC or MAC in a CSV format.

9

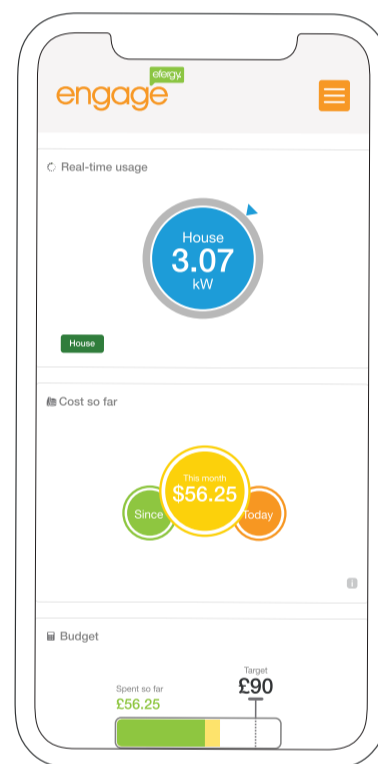

Monitor your home energy consumption on the go!

Download the **Efergy Engage** app free from the App Store or Google Play.



10

TECHNICAL INFORMATION

Model	engage hub kit	Transmission time	10/15/20s
Model number	HH-2.0	Transmission range	40 - 70m
Firmware version	3.7.0	Engage hub power	AC/DC
Frequency	433.5MHz		



CUSTOMER SUPPORT

If you have any questions about using your monitor or if you'd like further advice on monitoring electricity at home, please feel free to contact us or visit the website for up-to-date information, downloads and frequently asked questions.

Website: www.efergy.com

Support site: www.efergy.com/support

Technical support: customercare@efergy.com

Sales: sales@efergy.com

11



Engage
Installation guide